

AMERICAN MOTORS PARTS CATALOG

GROUP 23 DOORS - HARDWARE - VENTS

DESCRIPTION	GROUP AND FIGURE NO.	GROUP NO.
BRACKET, Door Check Link	23-13	23.096
BRACKET, Liftgate	23.024
BRACKET, Tailgate Counterbalance	23-11, 23-14	23.037
BRACKET, Tailgate Latch	23.039
BREAKER, Electric Operated Window Regulator Circuit	23.325
BUMPER, Door	23.019
BUTTON, Rear Door Lock Push	23-4, 23-5	23.054
CABLE, Tailgate Counterbalance	23-11, 23-14	23.037
CASE, Door and Rear Deck Lock	23-12	23.081
CHANNEL, Front Door Division Channel Glass Slide	23-8	23.125
CHANNEL, Front Door Glass and Ventilator Division	23-6, 23-7, 23-8	23.124
CHANNEL, Front Door Ventilator	23-6, 23-7	23.118
CHANNEL, Rear Door Division Channel Glass Slide	23-10	23.167
CHANNEL, Rear Door Glass and Ventilator Division	23-9, 23-10	23.165
CHANNEL, Rear Door Ventilator Weatherstrip	23-9	23.153
CONTROL, Door Lock Remote	23-1, 23-2, 23-3, 23-4, 23-5	23.056
COUPLING, Electric Operated Window Regulator Motor to Transmission	23.307
CRANK, Rear Door Locking	23-4, 23-5	23.057
CROSSARM, Door Window	23-7, 23-8	23.098
CYLINDER ASSY., Door Liftgate, Tailgate and Rear Deck Lock	23-1, 23-2, 23-3, 23-12, Refer Group 0, 25-1	23.081
DOOR, Front	23-1, 23-2, 23-3, 20-6, Refer Group 0	23.001
DOOR, Rear	23-4, 23-5, Refer Group 0	23.002
DOOR, Rear Deck	Refer Group 0	23.009
ESCUTCHEON, Door Window Regulator Handle	23-6, 23-7, 23-8, 23-9, 23-10	23.102
ESCUTCHEON, Remote Control Handle	23-1, 23-2, 23-3, 23-4, 23-5	23.059
FILLER, Front Door	23-3	23.012
FRAME, Door Window	23-1, 23-2, 23-4	23.008
FRAME, Front Door Ventilator	23-6, 23-7, 23-8	23.114
FRAME, Rear Door Ventilator	23-9, 23-10	23.152
FRAME ASSEMBLY, Front Door Ventilator	23-6, 23-7, 23-8	23.112
FRAME ASSEMBLY, Rear Door Ventilator	23-9, 23-10	23.151
GRIP, Tailgate Latch	23.039
GUIDE, Tailgate Counterbalance	23-11, 23-14	23.037
HANDLE, Door Outside	23-1, 23-2, 23-3, 23-4, 23-5, Refer Group 0	23.074
HANDLE, Door Window Regulator	23-6, 23-7, 23-8, 23-9, 23-10	23.100
HANDLE, Front Door Ventilator Lock	23-6, 23-7, 23-8	23.121
HANDLE, Rear Deck	Refer Group 0	23.078
HANDLE, Rear Door Ventilator Lock	23-9, 23-10	23.160
HANDLE, Remote Control	23-1, 23-2, 23-3, 23-4, 23-5	23.058
HANDLE ASSEMBLY, Liftgate	23.077
HANDLE ASSEMBLY, Tailgate	25-1	23.077
HARNESS, Door Electric Operated Window Regulator Wiring	23.320
HINGE, Front Door Lower	23-1, 23-2, 23-3	23.016
HINGE, Front Door Upper	23-1, 23-2, 23-3	23.015
HINGE, Liftgate	23.011
HINGE, Rear Deck Door	23.028
HINGE, Rear Door Lower	23-4, 23-5	23.018
HINGE, Rear Door Upper	23-4, 23-5	23.017
HINGE, Tailgate	23-14, Refer Group 0	23.006
HOUSING, Electric Operated Window Regulator Transmission	23.308
KEY, Lock Cylinder	23-1, 23-12, 25-1	23.085
LATCH, Tailgate	23-14	23.039
LETTER, Rear Deck Door Name	Refer Group 0	23.009

AMERICAN MOTORS PARTS CATALOG

DESCRIPTION	GROUP AND FIGURE NO.	GROUP NO.
LINK, Door Check	23-1, 23-4, 23-5, 23-13	23.033
LINK, Front and Rear Door	23-1, 23-2, 23-3, 23-4, 23-5	23.055
LINK, Rear Door Locking	23-4, 23-5	23.057
LOCK, Front Door	23-1, 23-2, 23-3	23.050
LOCK, Liftgate	23.070
LOCK, Rear Deck	23.070
LOCK, Rear Door	23-4, 23-5	23.051
MOTOR, Electric Operated Window Regulator	23.310
NAMEPLATE, Rear Deck	Refer Group 0	23.009
PANEL, Front Door	23-1, 23-2, 23-3	23.001
PANEL, Liftgate	23.011
PANEL, Rear Door	23-4, 23-5	23.002
PANEL, Tailgate	23-14, Refer Group 0	23.006
PIN, Door Hinge	23.023
PIN, Door Window Regulator Handle	23-6, 23-7, 23-8, 23-9, 23-10	23.107
PIN, Remote Control Handle	23-1, 23-2, 23-3, 23-4, 23-5	23.063
PLATE, Front Door Ventilator Friction Unit	23-6, 23-7, 23-8	23.123
PLATE, Rear Deck Door Name	23.009
PLATE, Rear Door Ventilator Friction Unit	23-9, 23-10	23.163
REGULATOR, Front Door Electric Operated Window	23.300
REGULATOR, Rear Door Electric Operated Window	23.305
REGULATOR, Tailgate Window	25-1	23.040
REGULATOR ASSEMBLY, Door Window	23-6, 23-7, 23-8, 23-9, 23-10	23.098
ROD, Rear Door Locking Control	23-4, 23-5	23.057
SCREW, Door Hinge	23-1, 23-2, 23-3, 23-4, 23-5	23.020
SEAL, Tailgate	23-14	23.006
SEALER, Front Door	23-1, 23-2, 23-3	23.012
SEALER, Rear Door	23-4, 23-5	23.012
SEALER, Rear Door Ventilator	23-10	23.154
SHAFT, Door and Rear Deck Lock	23-12	23.081
SPRING, Cylinder Lock Retainer	23-1, 23-2, 23-3	23.086
SPRING, Front Door Lock Trip Lever Return	23-1, 23-2, 23-3	23.050
SPRING, Front Door Ventilator Friction Unit	23-6, 23-7, 23-8	23.123
SPRING, Rear Door Lock Trip Lever Return	23-4, 23-5	23.051
SPRING, Rear Door Ventilator Friction Unit	23-9, 23-10	23.163
SPRING, Tailgate Counterbalance	23-11, 23-14	23.037
STRIKER, Door Lock	23-1, 23-2, 23-3, 23-4, 23-5	23.087
STRIKER, Rear Deck Lock	23.073
SUPPORT, Liftgate (On Body)	23.034
SUPPORT, Tailgate	23-14	23.036
SWITCH, Electric Operated Window Regulator Control	23.330
SWIVEL, Door and Rear Deck Lock	23-12	23.081
TAILGATE	23-14 Refer Group 0	23.006
VENTILATOR, Front Door	23-6, 23-7, 23-8	23.110
VENTILATOR, Rear Door	23-9, 23-10	23.150
WASHER, Door Window Regulator Handle	23.104
WASHER, Front Door Ventilator Friction Unit	23-6, 23-7, 23-8	23.123
WASHER, Rear Door Ventilator Friction Unit	23-9, 23-10	23.163
WEATHERSEAL, Front and Rear Door	23-2, 23-3, 23-4, 23-5	23.012
WEATHERSTRIP, Front Door Glass and Ventilator Division Channel	23-6, 23-8	23.117
WEATHERSTRIP, Front Door Ventilator	23-6, 23-7, 23-8	23.116
WEATHERSTRIP, Rear Door Division Channel	23-10	23.166
WEATHERSTRIP, Rear Door Ventilator	23-9, 23-10	23.154

AMERICAN MOTORS PARTS CATALOG

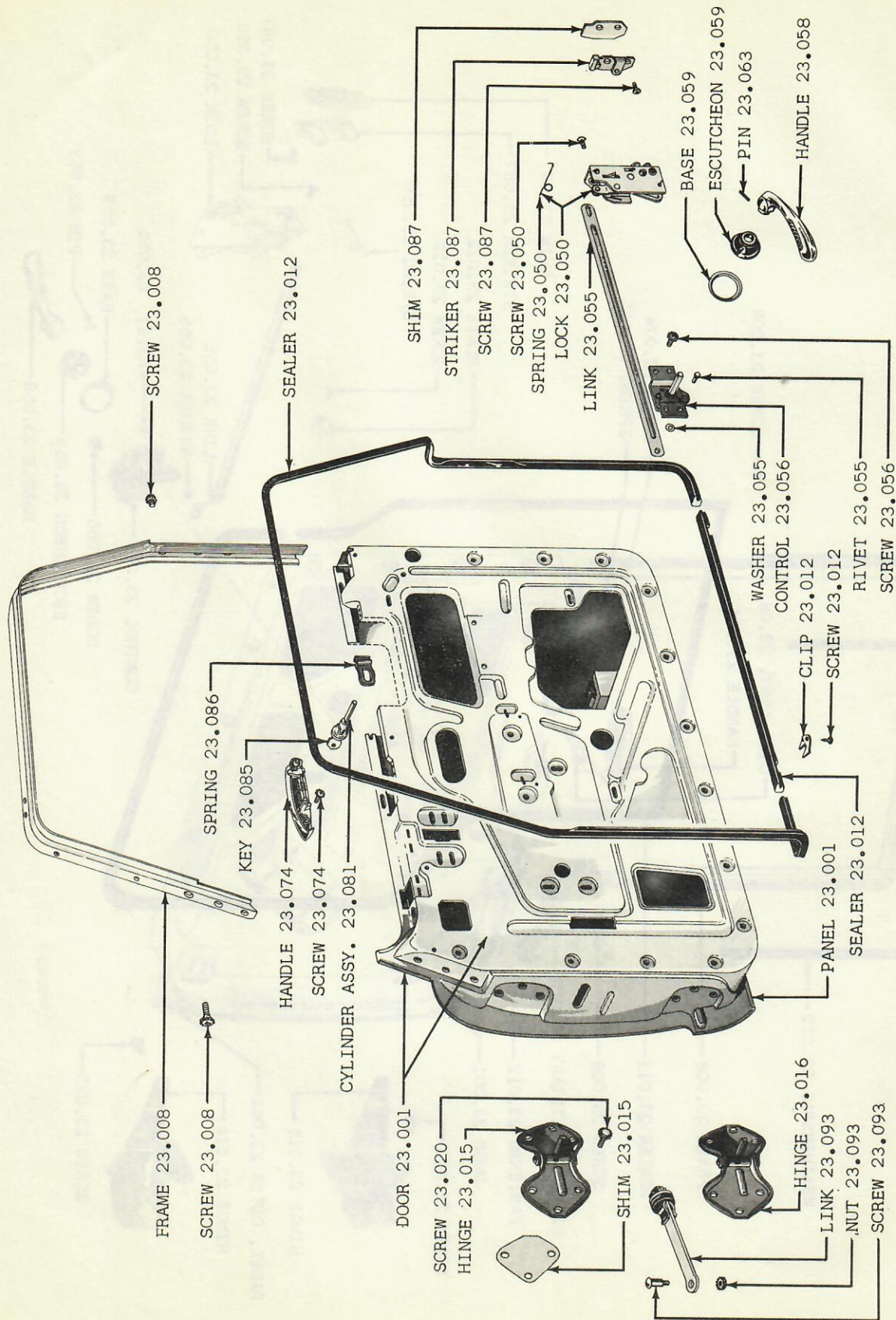

GROUP 23 - FIG. 1 - FRONT DOOR, HARDWARE AND SEALERS 01

AMERICAN MOTORS PARTS CATALOG

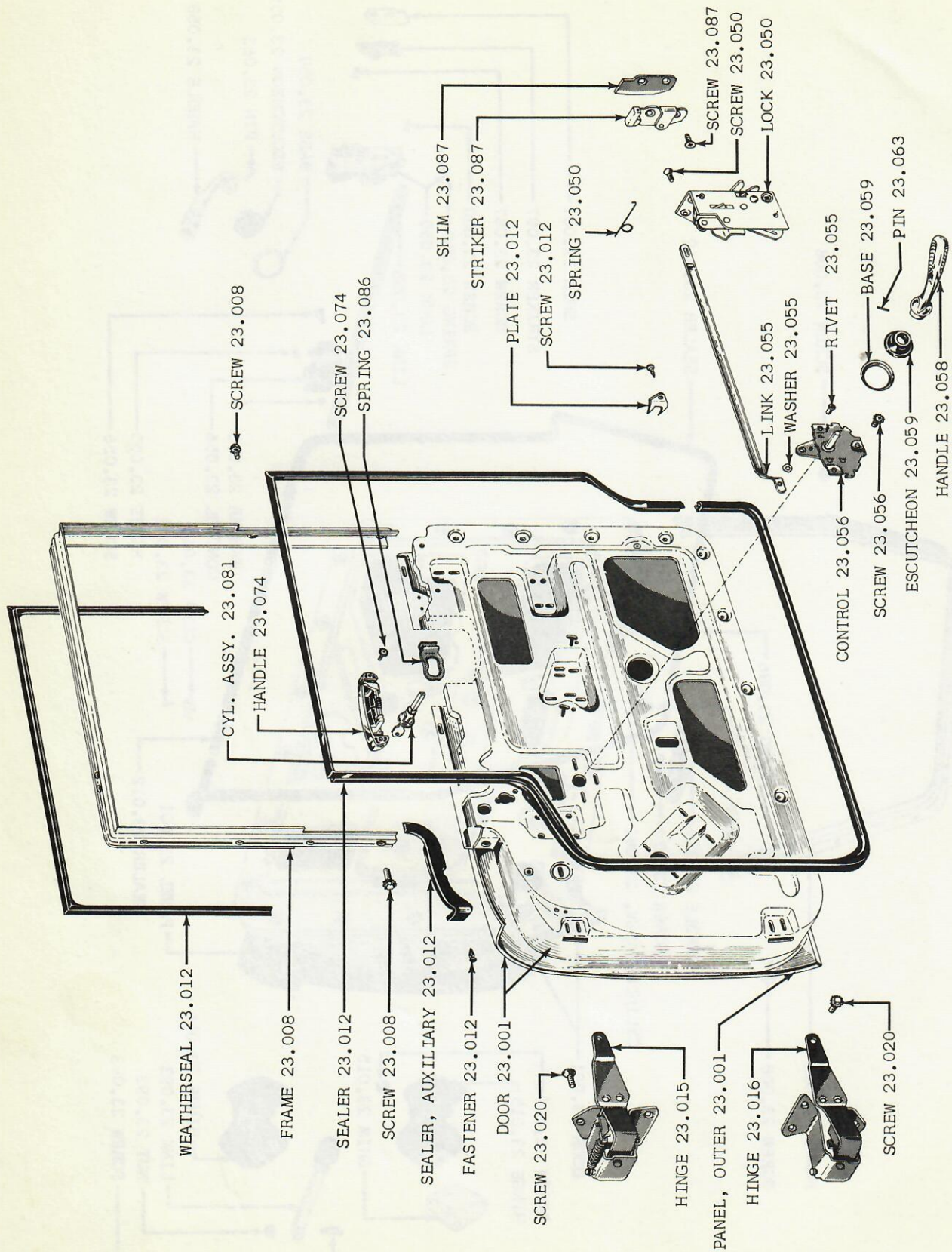

GROUP 23 - FIG. 2 - FRONT DOOR. HARDWARE AND SEALERS 15-18-25-28-85-88

AMERICAN MOTORS PARTS CATALOG

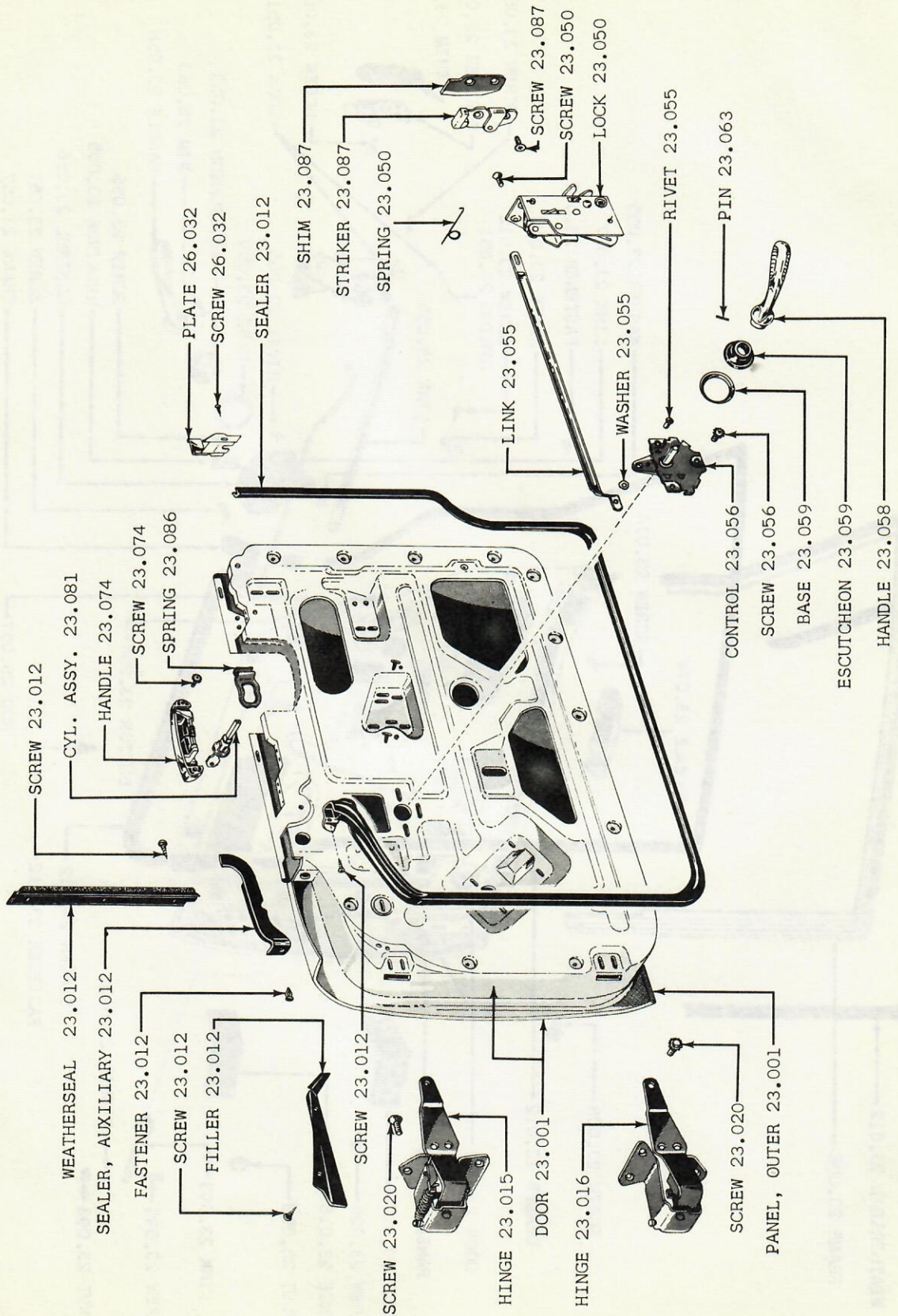

GROUP 23 - FIG. 3 - FRONT DOOR, HARDWARE AND SEALERS 19-23-29-83-89

AMERICAN MOTORS PARTS CATALOG

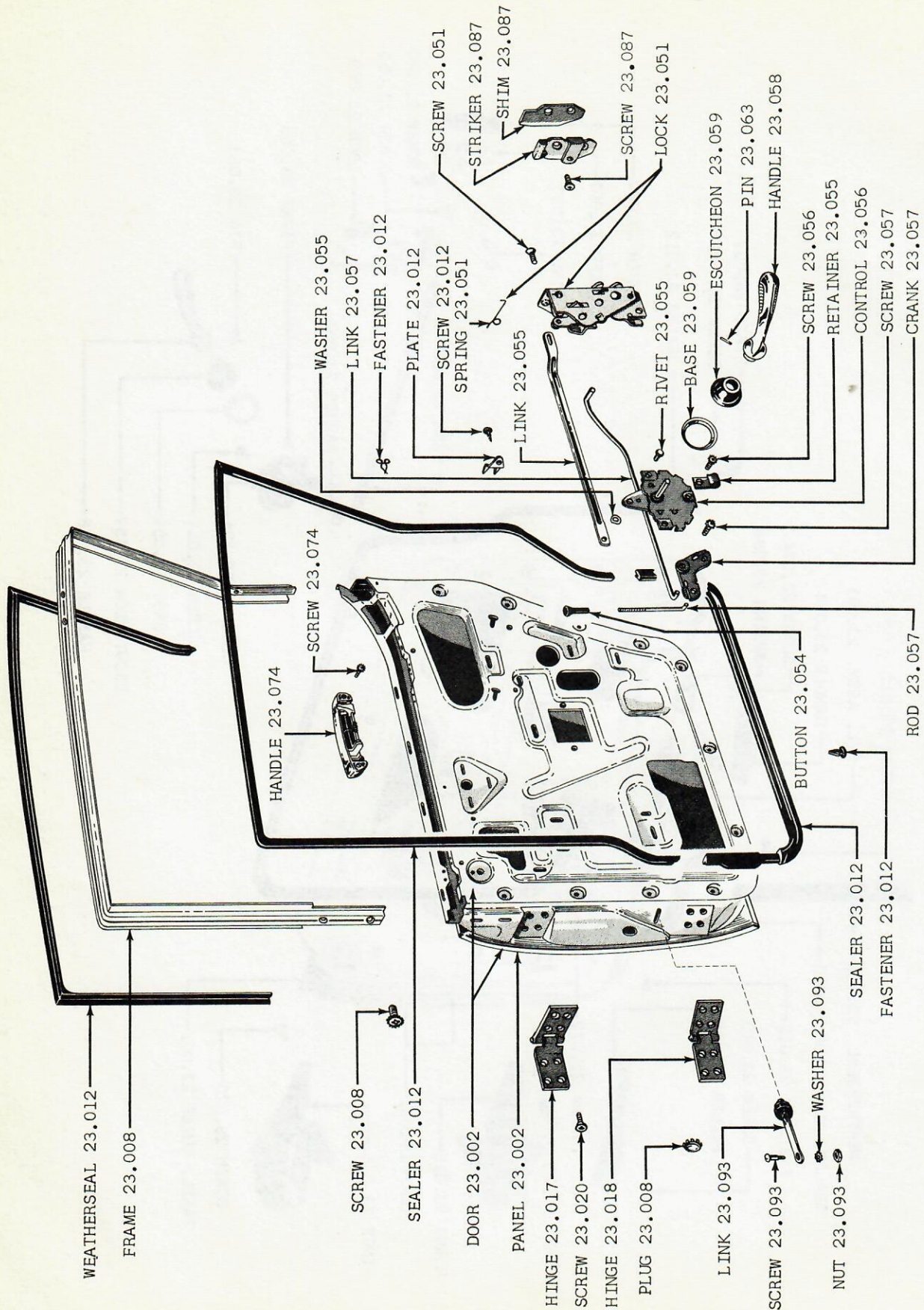

GROUP 23 - FIG. 4 - REAR DOOR, HARDWARE AND SEALERS 15-18, 25, 28, 85, 88

AMERICAN MOTORS PARTS CATALOG

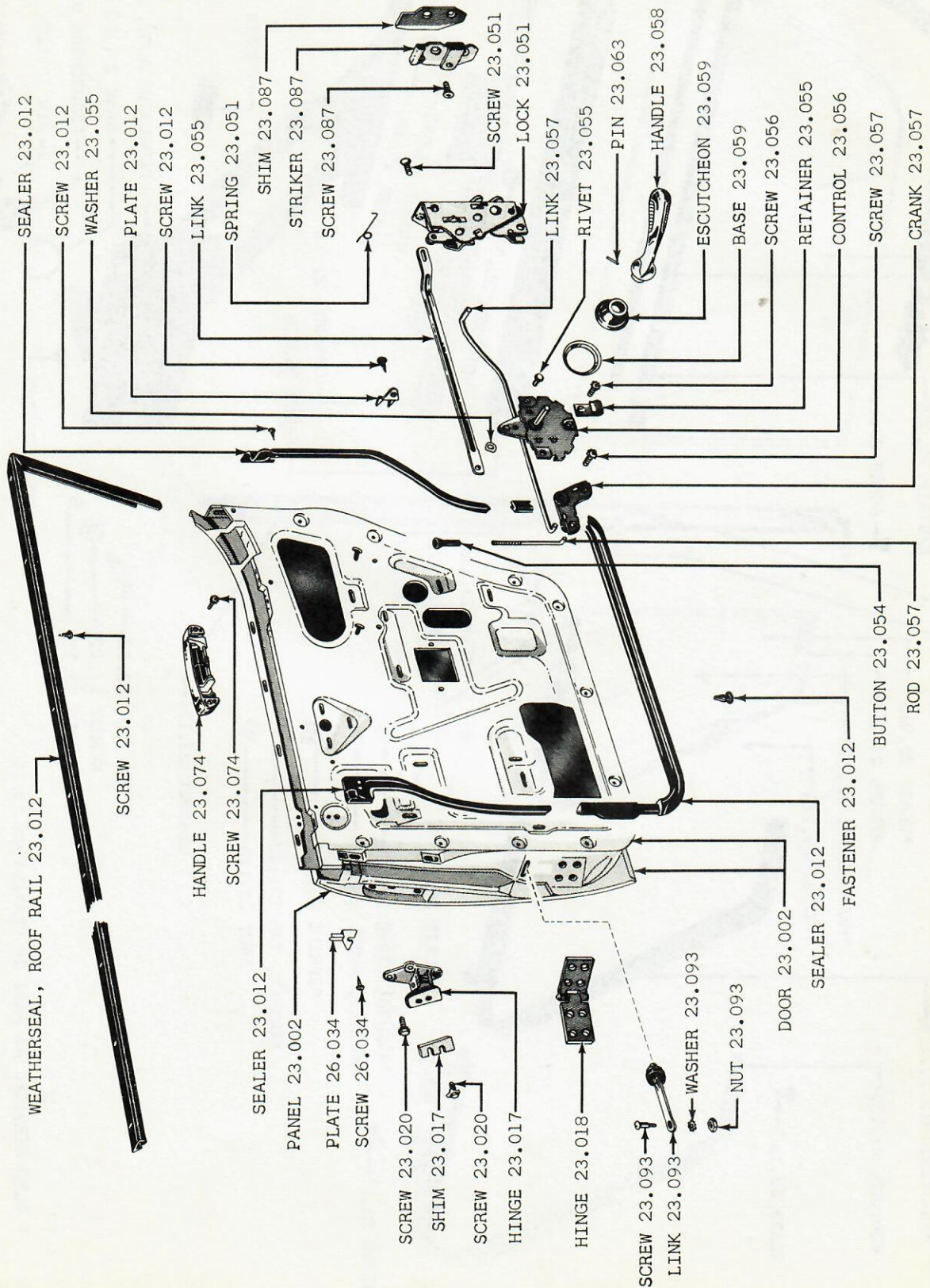

GROUP 23 - FIG. 5 - REAR DOOR, HARDWARE AND SEALERS 19-23-29-83-89

AMERICAN MOTORS PARTS CATALOG

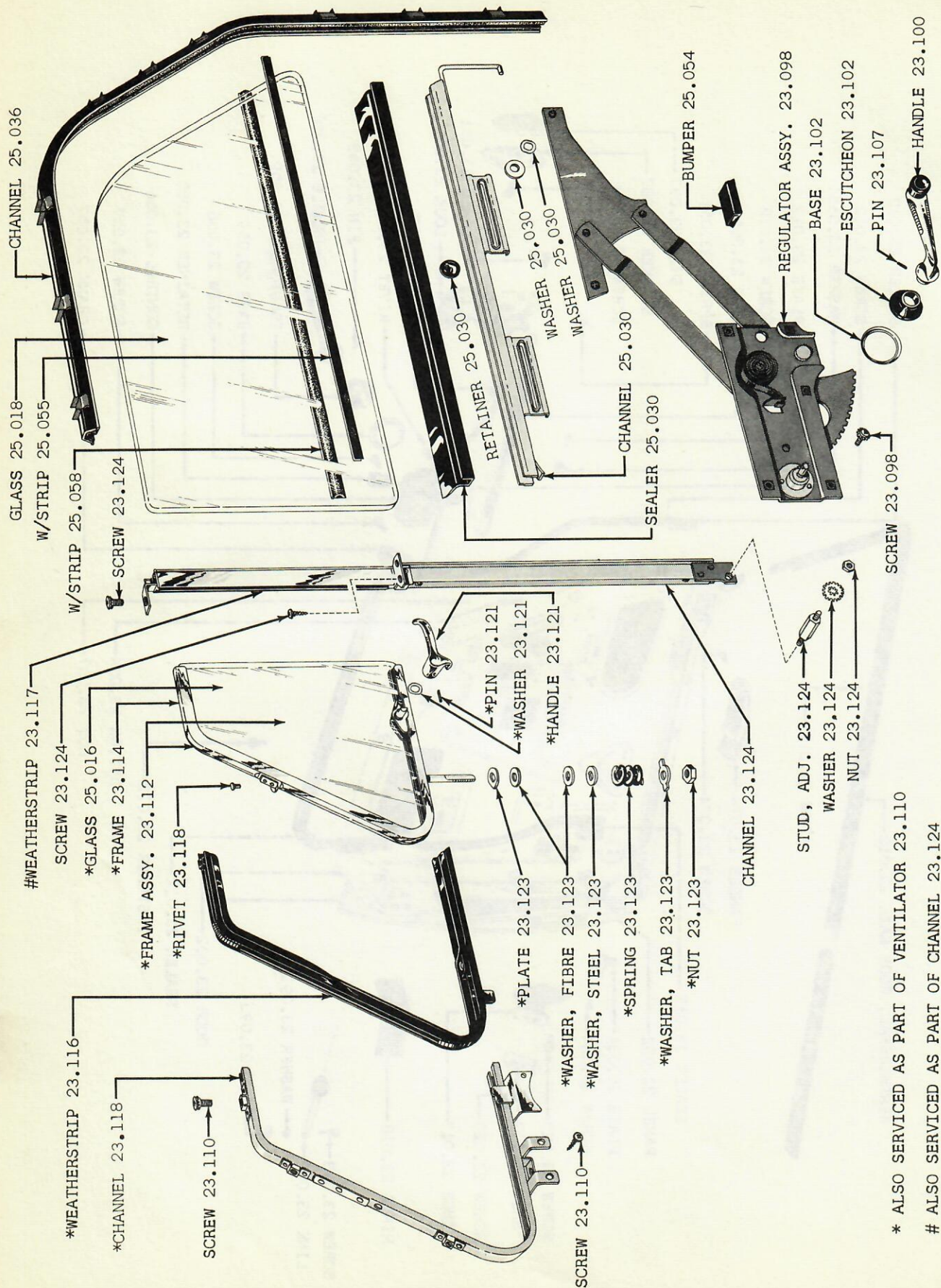

* ALSO SERVICED AS PART OF VENTILATOR 23.110
 # ALSO SERVICED AS PART OF CHANNEL 23.124

GROUP 23 - FIG. 6 - FRONT DOOR GLASS AND CHANNELS 01

AMERICAN MOTORS PARTS CATALOG

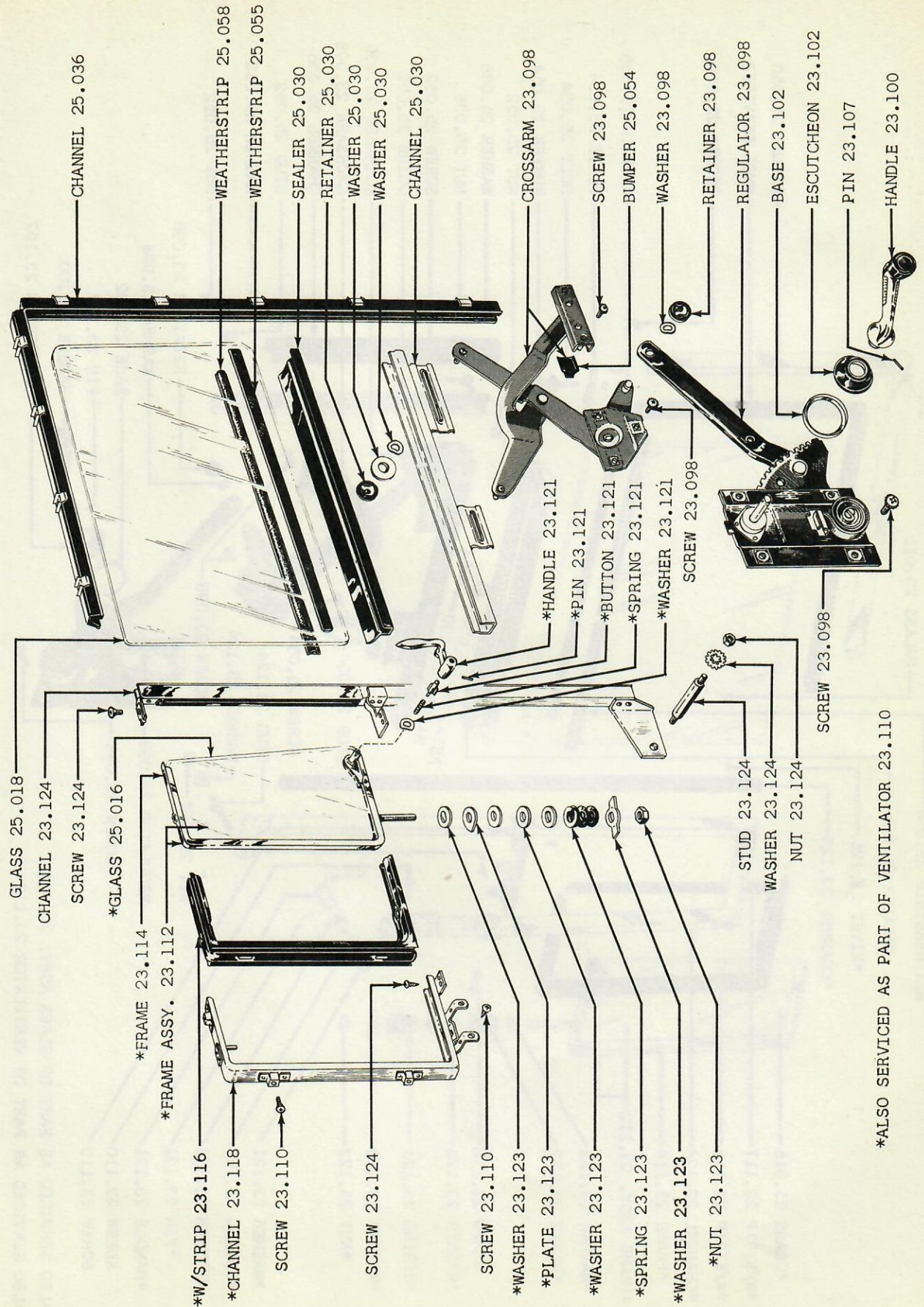

*ALSO SERVICED AS PART OF VENTILATOR 23.110

GROUP 23 - FIG. 7 - FRONT DOOR GLASS AND CHANNELS 15-18-25-28-85-88

AMERICAN MOTORS PARTS CATALOG

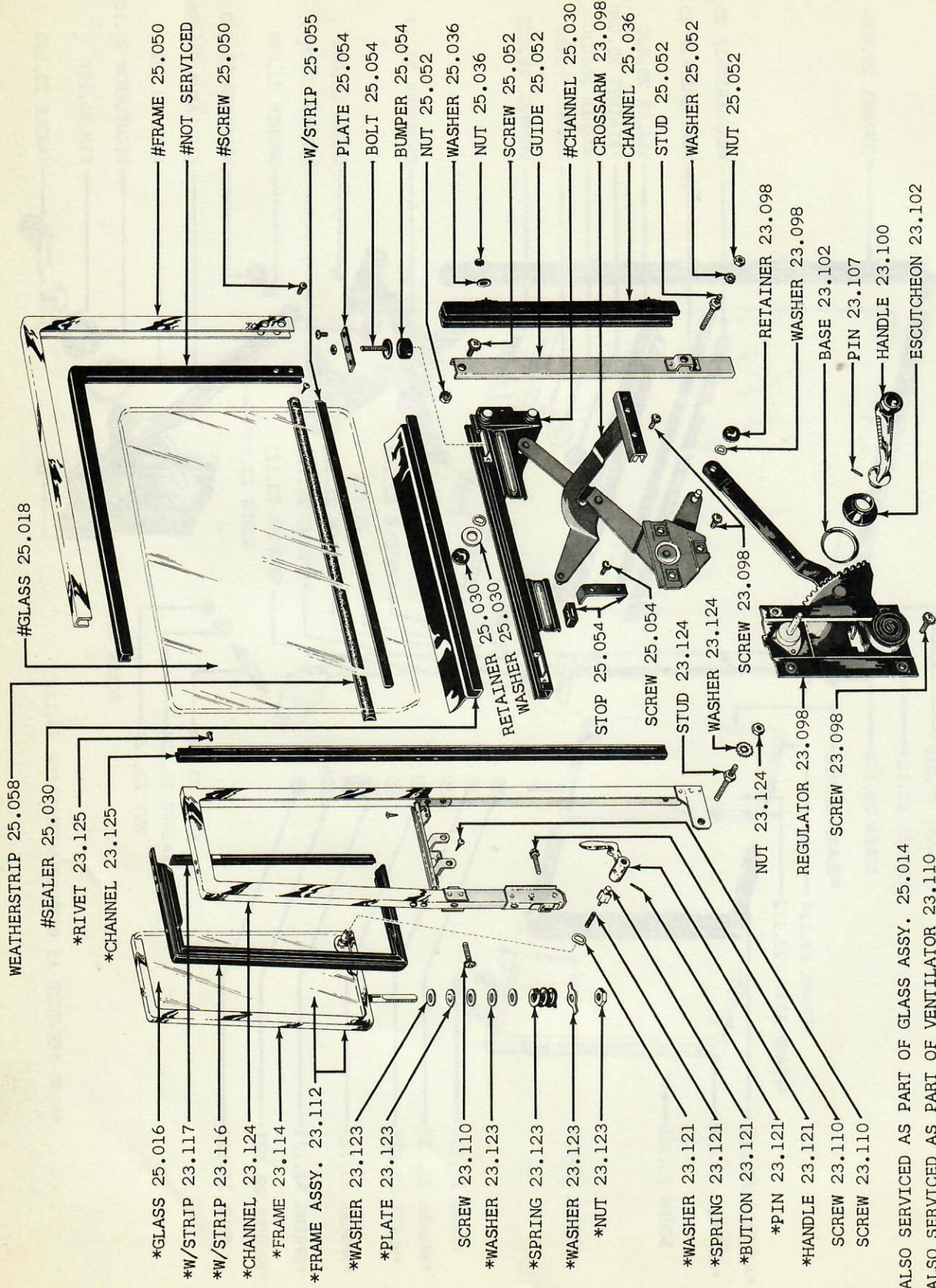

#ALSO SERVICED AS PART OF GLASS ASSY. 25.014
 *ALSO SERVICED AS PART OF VENTILATOR 23.110

GROUP 23 - FIG. 8 - FRONT DOOR GLASS AND CHANNELS 19-23-29-83-89

AMERICAN MOTORS PARTS CATALOG

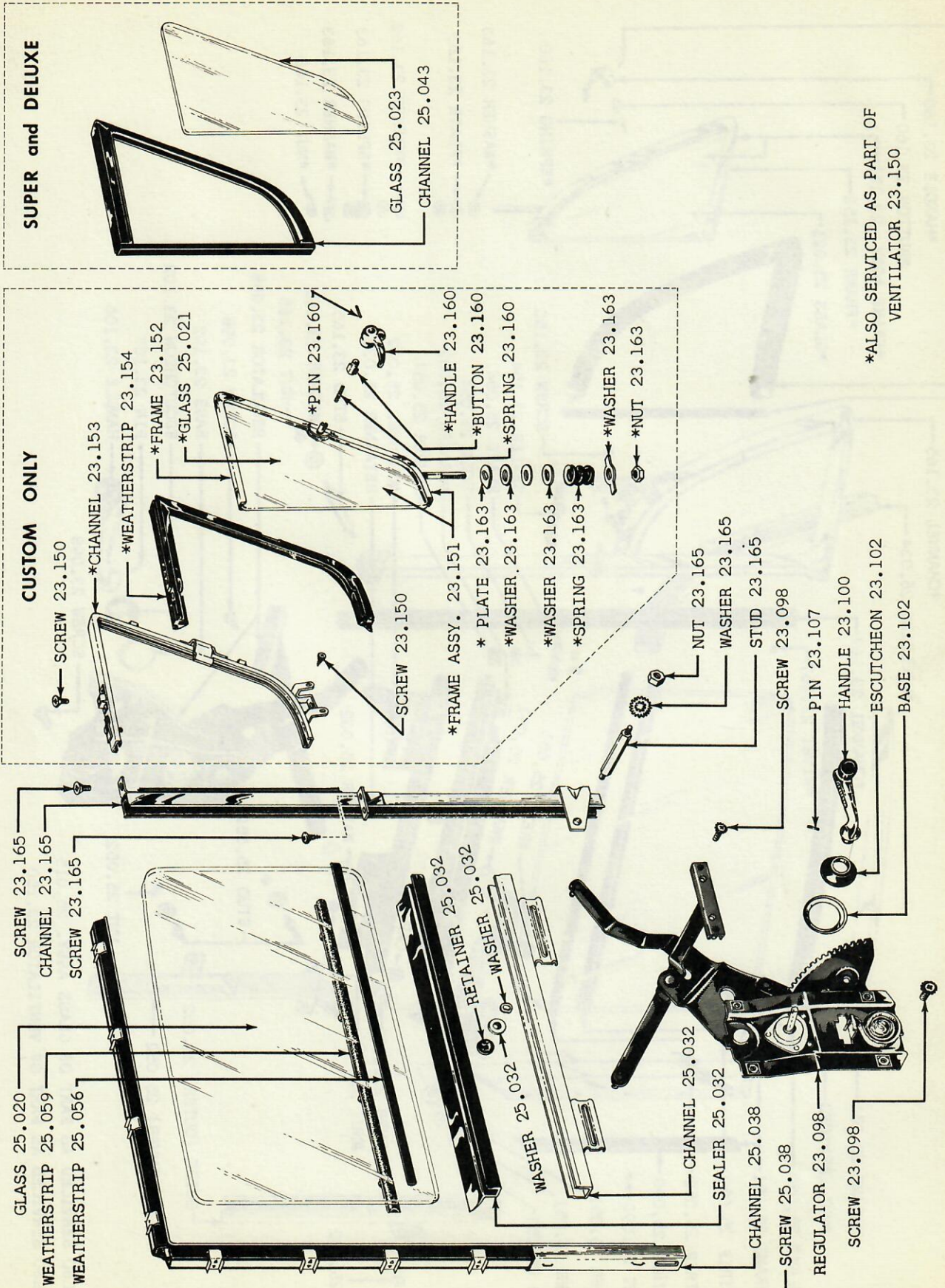

GROUP 23 - FIG. 9 - REAR DOOR GLASS AND CHANNELS 15-18-25-28-85-88

AMERICAN MOTORS PARTS CATALOG

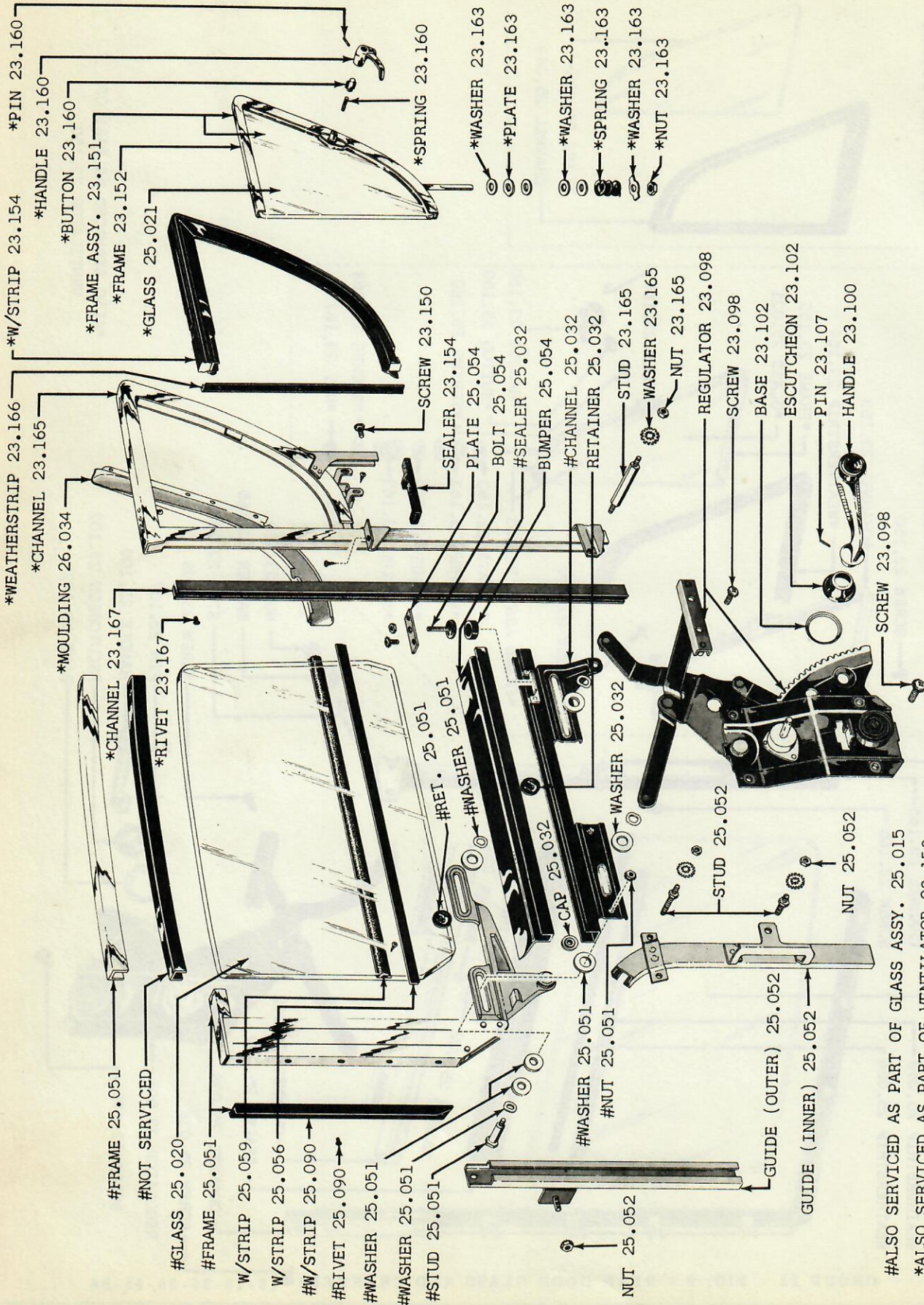

#ALSO SERVICED AS PART OF GLASS ASSY. 25.015
 *ALSO SERVICED AS PART OF VENTILATOR 23.150

GROUP 23 - FIG. 10 - REAR DOOR GLASS AND CHANNELS 19-23-29-83-89

AMERICAN MOTORS PARTS CATALOG

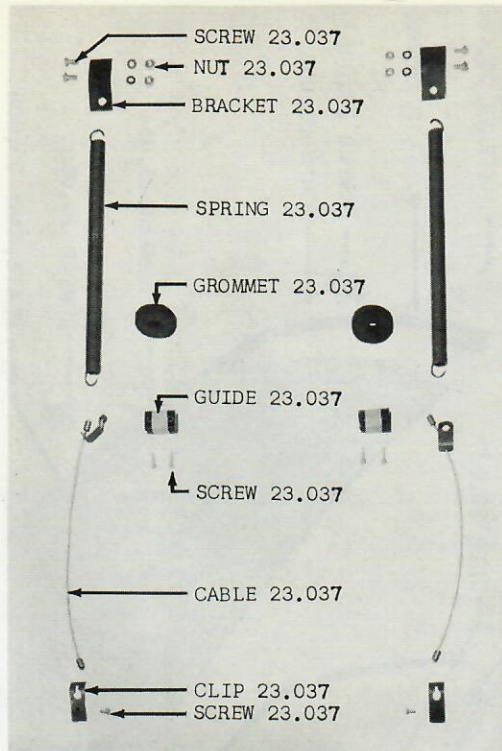

GROUP 23 - FIG. 11 - TAILGATE COUNTERBALANCE ASSEMBLY 18-28-83-88

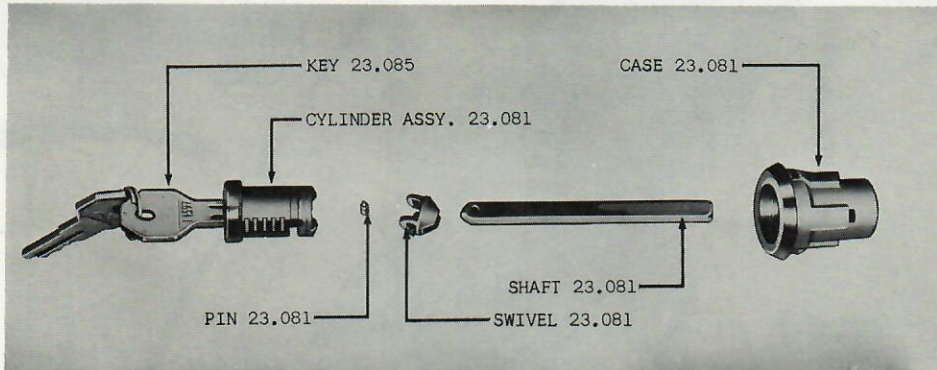

GROUP 23 - FIG. 12 - DOOR LOCK CYLINDER AND KEYS 01-10-20-80

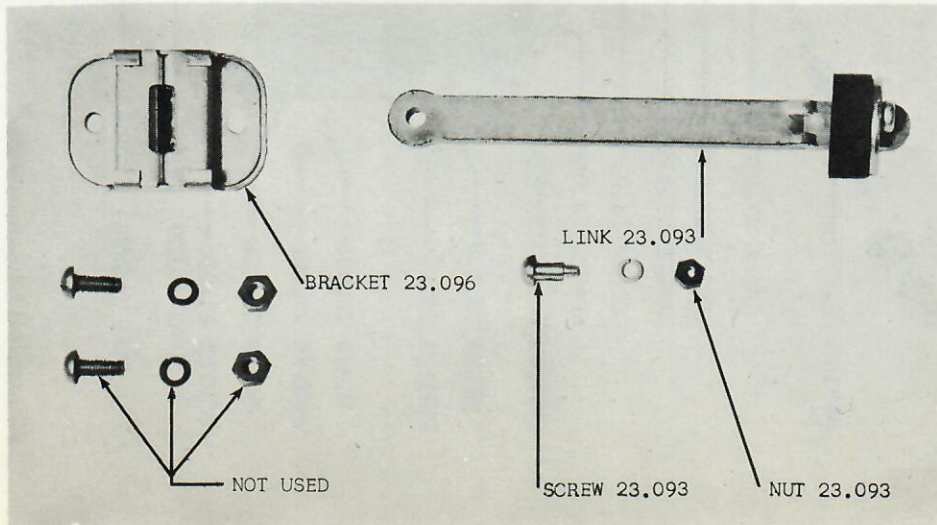

GROUP 23 - FIG. 13 - REAR DOOR CHECK LINK 10-20-80

AMERICAN MOTORS PARTS CATALOG

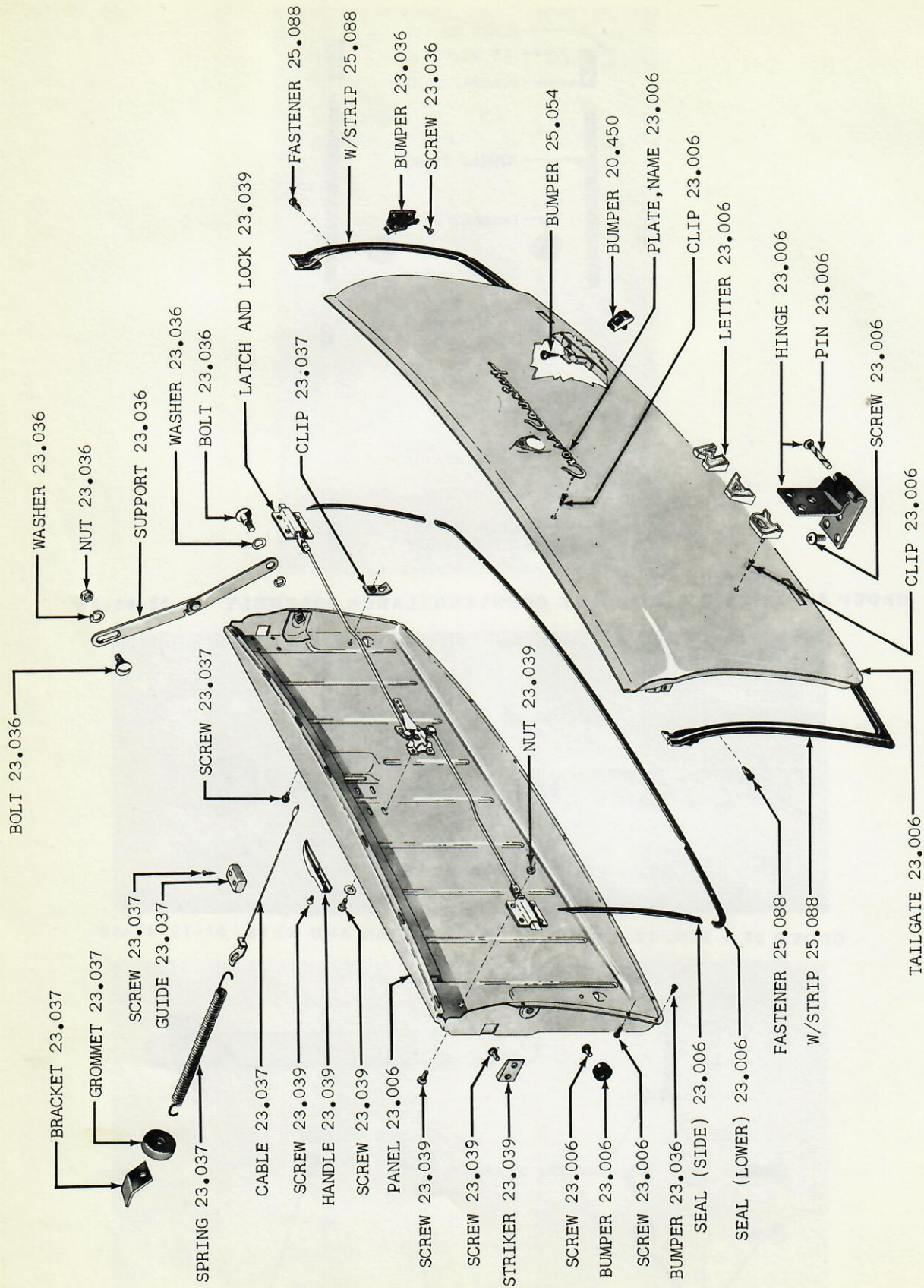

GROUP 23 - FIG. 14 - TAILGATE, HARDWARE AND SEALERS 18-28-83-88